

Whale Supersub 360/500 Electric Bilge Pumps

Read Carefully Before Installation and Use.

To the Fitter:

Check that the product is suitable for the intended application, follow installation instructions and ensure all relevant personnel read the points listed below. Also ensure that operating instructions are passed on to the end user.

To the User:

Read the following instructions carefully.

Application:

This product is designed primarily for use as a bilge pump. This electric bilge pump is designed to pump normal bilge water. Output capacity depends on installation and operating conditions. If this product is intended to be used for any other purpose or with any other liquid, it is the user's responsibility to ensure that the pump is suitable for the application and, in particular, that the materials are fully compatible with the liquids to be used.

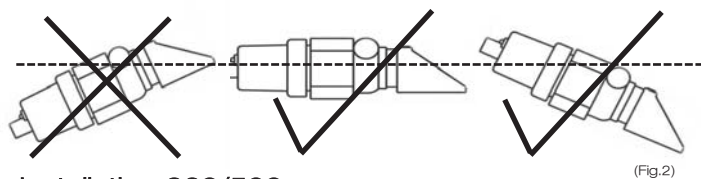
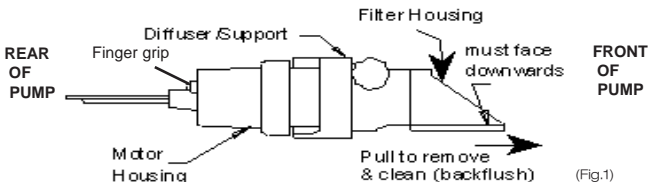

Installation 360/500

1. The pump should be positioned where accumulated water is deepest. It should be located for easy access in a position which best protects the unit from damage and allows fitting without penetrating the hull.
2. For best performance it is recommended to mount the pump horizontally (Fig.2). Mark two hole positions using the template provided.
3. Rotate motor housing in an anticlockwise direction using the finger grip at the rear of the pump to remove it from the diffuser.
4. Use the 2 self-tapping panhead screws and washers provided to secure diffuser housing in most appropriate position for outlet direction. Refit motor housing into position by twisting the motor housing clockwise until it clicks into place.
5. Fit 19 mm (¾") I.D. reinforced hose onto outlet port while supporting the diffuser housing. Secure using hose clips.
6. Fit an in-line non-return valve to prevent back filling. For reliable operation and to comply with warranty conditions, electrical connections must be positioned above the normal bilge water level. A submerged splice will render this warranty null and void. Use a 3 Amp

Automotive fuse for Supersub 360 pump, and a 5 Amp Automotive fuse for Supersub 500. Supersub 360 and 500 pumps should be wired through a float switch or can be manually switched on and off. (For example Whale's Automatic floatswitch BE9002).

Electrical Wiring

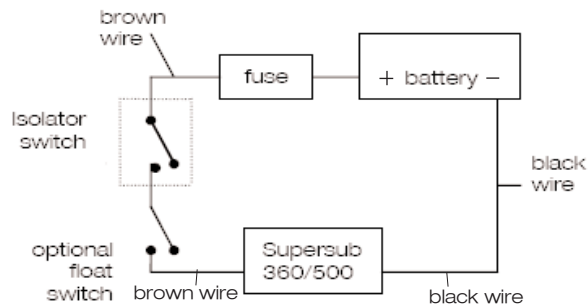

Maintenance

Warning: Turn off power before removing filter housing or motor housing from diffuser. Regular inspection and cleaning of the filter housing is recommended. Ensure that no fibrous debris is allowed to build up on the impeller and shaft as this will reduce performance and damage the pump.

Helpful Hints:

1. For best pump performance ensure battery voltage does not fall below 10V d.c.
2. To avoid possible pump damage, ensure outlet hose does not become blocked or kinked.
3. For best pump performance keep the outlet hose and wire lengths as short as possible with wire ends above highest water level.
4. Ensure debris and dirt do not build up in the filter housing.
5. To clean, pull entire filter housing (see fig.1) from pump and backflush.

EU Declaration of Conformity

We herewith declare that the Supersub range conforms with the provisions of the following EC Directives:

Electromagnetic Compatibility Directive 89/336/EEC, amended by 92/31/EEC and 93/68/EEC on the approximation of the laws of the member states. CE mark affixed: 26/06/06

Basis on which conformity is declared: the Supersub range complies with the protection requirements of the EMC Directive. Standards applied:

EN55014-1:2000

EN55014-2:1997

Signed:



David Cresswell
Position: Engineering Director
Date: 23/05/06

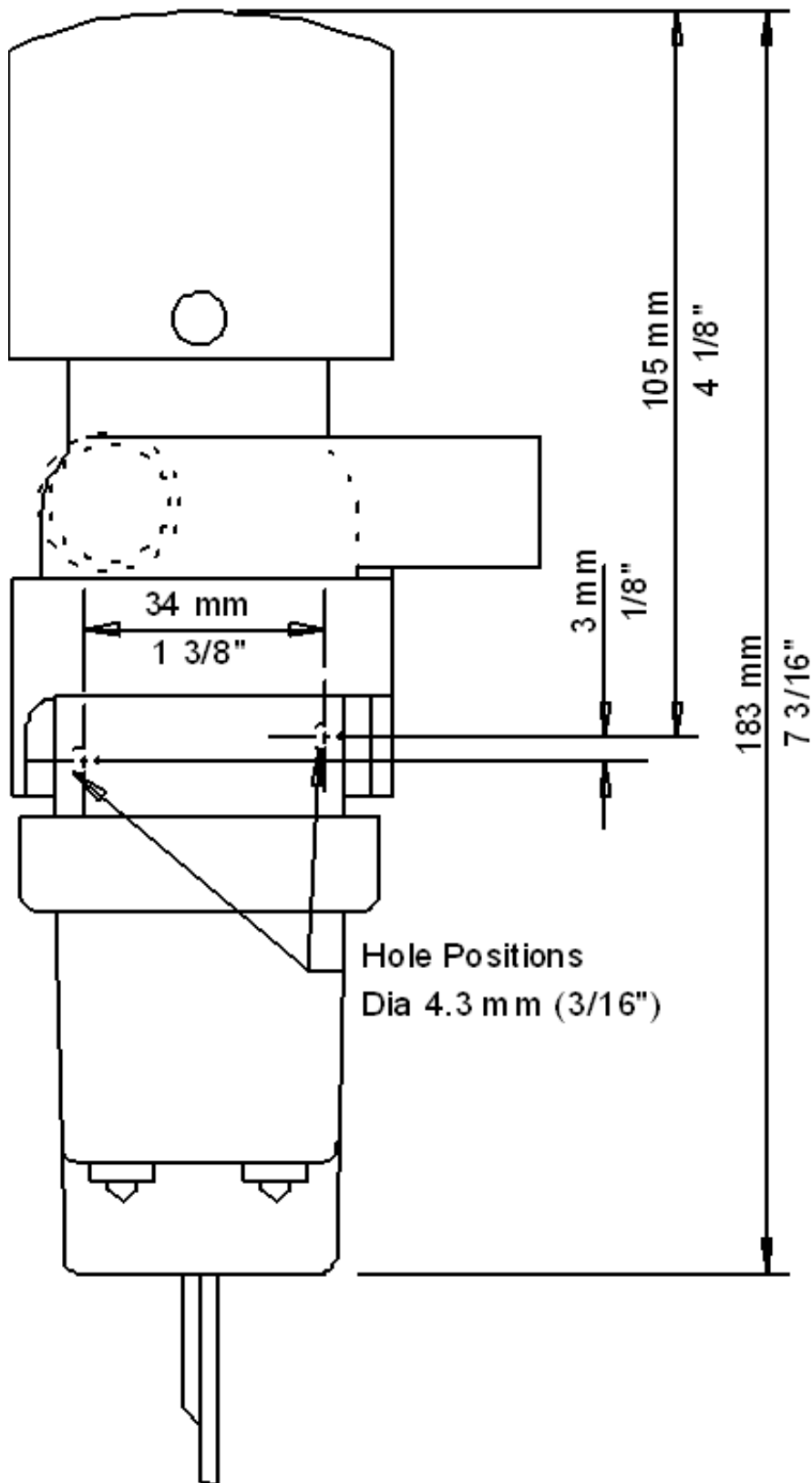



Whale Supersub 360/500 Electric Bilge Pumps

Disclaimer

All Whale products are rated and appropriate for use with water unless otherwise specified. Compatibility and suitability for other liquids should be verified prior to such use. All specification information on products included in this literature is based on tests using clean cold water unless otherwise specified. The performance / specification figures shown have been calculated using standard testing procedures. Where maximum output is stated, such maximum output refers to pumps acting at zero lift and zero head. Actual performance may vary depending on the application, installation and environmental factors. Neither the accuracy nor completeness of the information contained in this literature is guaranteed by Munster Simms Engineering Limited and Whale Water Systems Inc. (a wholly owned subsidiary of Munster Simms Engineering Limited) and may be subject to change at its sole discretion. Munster Simms Engineering Limited and Whale Water Systems Inc. (a wholly owned subsidiary of Munster Simms Engineering Limited) may, at its sole discretion, change the technical performance, dimensions or appearance of any of its Whale products without prior notification to a purchaser. Munster Simms Engineering Limited and Whale Water Systems Inc. (a wholly owned subsidiary of Munster Simms Engineering Limited) shall not be liable to a purchaser for any indirect or consequential loss or damage (whether for loss of profit, loss of business, depletion of goodwill or otherwise), costs, expenses or other claims for consequential compensation whatsoever (howsoever caused) which arise out of or in connection with the use of a Whale product.

Where dimensions are stated, such dimensions are for guidance only. Inch measurements are conversions from millimetre dimensions and are shown to the nearest $\frac{1}{16}$ ". US gallons volumes are conversions from litres and are also shown for guidance purposes only to the nearest $\frac{1}{16}$. Please contact Whale if precise measurements are required.

Warranty

Whale Supersub range is guaranteed for one year from date of purchase, and are subject to the following conditions:-

Statement of Limited Warranty

The products manufactured by Munster Simms Engineering Limited (Whale Water Systems Inc.) (the "Company"), are warranted to be free from defects in design, workmanship and material under normal use, save that this warranty shall not apply where the defect or fault is attributable to defective materials supplied by third parties where the Buyer's only remedy will be against that third party. This warranty applies only to products that are properly installed and used in accordance with all maintenance and operation instructions provided by the Company. Whale products are covered by a 1 year limited warranty (detailed below) from date of purchase, with the following enhancements:

- Manual Bilge Pumps, Manual Freshwater, Manual Toilet Pumps:
5 years from date of purchase (except for Smartbail which is covered for 3 years from date of purchase).
- Electric Freshwater Pumps:
1 year from date of purchase except Universal Pumps which are 2 years from date of purchase.
- Orca Bilge Pump Range:
3 years from date of purchase.
- Quick Connect Plumbing (fittings and WhaleX tubing only):
Whale Quick Connect fittings and WhaleX tubing (only) are covered for 10 years from date of purchase.

The Company reserves the right to repair, replace or issue a spares kit for the defective item subject to examination at Company premises. Adjustment or replacement of defective parts made under this warranty will not extend the original warranty period. The Company is not obligated to bear any costs of removal, installation, transportation, or other charges that may arise in connection with a warranty claim. No claim in respect of defective goods will be valid unless the alleged defective goods are returned at the Purchaser's expense to the Company for inspection with proof of purchase.

Products that have been disassembled or modified (without prior approval of the Company), are not included in the Company's warranty.

Non- stock/ special order items are non-returnable, and warranty does not apply to prototype models.

Exclusions:

Nothing in this clause shall be deemed to exclude or restrict the Company's liability for death or personal injury resulting from its negligence. The Company shall not be liable for any indirect loss or for any special, incidental, punitive or consequential damages suffered by the Purchaser and/or any other person whether this loss arises from breach of a duty in contract or tort or breach of a statutory duty or in any other way including without limitation loss arising from the negligence, default, breach of duty, non-delivery, delay in delivery or defects or errors in the work undertaken by the Company pursuant to the terms of this statement or in connection with any other claim.

- In particular the Company shall not be liable (without limitation) for:
- Loss of profits, increased production costs or other economic injury or loss;
 - Loss of contracts or opportunity;
 - Damage to property of the purchaser or anyone else;
 - Personal injury to the purchaser or anyone else except insofar as such injury is attributable to the Company's negligence;

The Company shall under no circumstances be liable for any loss, damage, detention, delay or failure to perform hereunder (other than failure to pay money) resulting from causes beyond its control including but not limited to fires, strikes, lockouts, insurrection or riots, terrorism or civil disorder, embargoes, wrecks or delays in transportation, requirements or regulations of any governmental authority, tempest, earthquake or other natural disaster, flood, bursting or overflowing of water tanks, failure or shortage of power, fuel or other utilities, or loss of data and/or communications due to causes such as those referred to in this clause, outside the Company's control.

This statement sets out the Company's entire liability in respect of the products and the Company's liability under this statement shall be in lieu of all other warranties, conditions, terms and liabilities, express or implied, statutory or otherwise howsoever except any implied by law which cannot be excluded.

The above does not affect the statutory rights of the consumer.

The Company shall NOT be liable for any condition, warranty or representation made by a Distributor or other person acting on behalf of the Company unless expressly authorised by the Company to do so.

This statement shall be governed and construed in accordance with Northern Irish law and all disputes arising in connection with the statement shall be submitted to the jurisdiction of the Northern Irish Courts.

180.41/V3/0207